

Single Groove Rollers

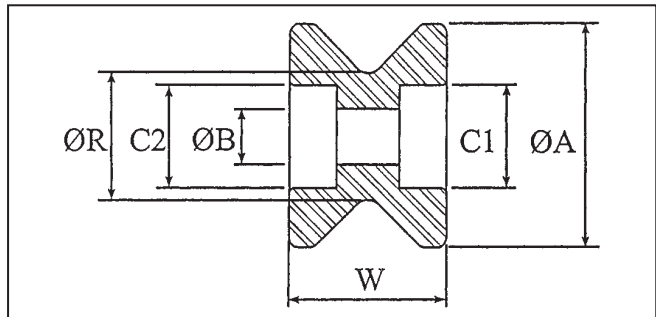

CS = countersunk bore for screw

Ref.	øA	øB	øR	W	øC1	øC2
T34	14.0	3.2	10.0	8.0		
T2	14.0	4.3	10.0	10.0		
T42	14.0	3.5	8.0	10.0	6.5 x 3.0	
T3	16.0	4.0	10.0	9.0		
T4U	16.5	4.0	8.5	9.0		
T4V	16.5	4.0	8.5	9.0		
T28	17.0	4.0	10.0	9.0		
T37	17.0	5.0	8.0	7.0		
T25	17.0	6.0	8.0	11.0		
T47	17.0	3.3	10.0	9.5		
T32	18.0	5.0	10.0	8.0		
T23	18.2	3.3	9.5	9.0	8.0 x 0.5	
T9	19.0	3.2	10.2	12.8		
T33	20.0	4.3	9.5	11.0	10.0 x 2.0	
T45	20.0	4.3	10.0	14.1	14.4 x 2.0	14.4 x 2.0
T44	20.0	6.0	8.0	10.0		
T13A	20.5	5.0	10.0	13.5	CS	
T13	20.5	3.0	10.0	13.6	7.8 x 3.0	
T36	23.5	9.6	15.0	8.0		
T35	24.9	6.0	14.1	13.1	9.0 x 1.5	
T15	25.0	6.0	10.0	18.0	9.0 x 1.5	
T38	25.6	4.0	20.0	7.8	15.2 x 1.3	15.2 x 1.3



Ref.	øA	øB (to clear)	øR	W	øC1	øC2
T26*	29.3	6.0	16.5	14.0	9.0 x 1.5	9.0 x 0.8
T27*	29.3	6.0	10.0	14.0	9.0 x 1.5	9.0 x 0.8
T39	29.8	6.0	17.2	9.0	9.0 x 2.0	9.0 x 0.8
T21	38.7	4.0	26.0	9.0		
T21A	38.7	6.3	26.0	9.0		
T29	39.0	10.0	21.0	16.0		
T30	39.0	15.0	21.0	16.0		

*asymmetric groove

Drawings available upon request