

Autoconer Guides

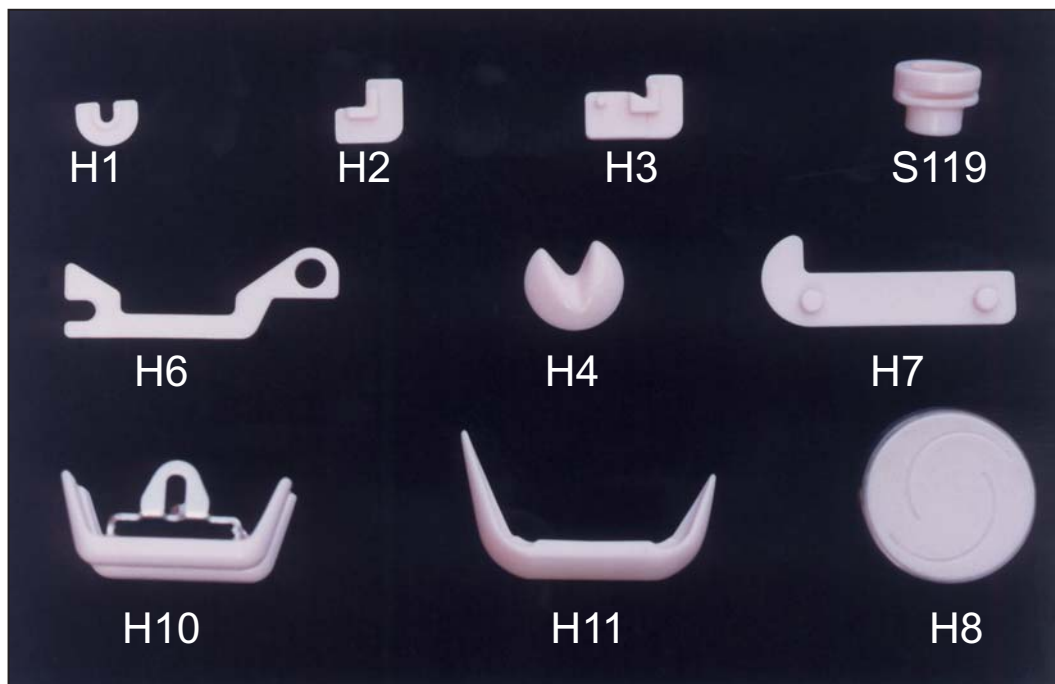

OE Guides

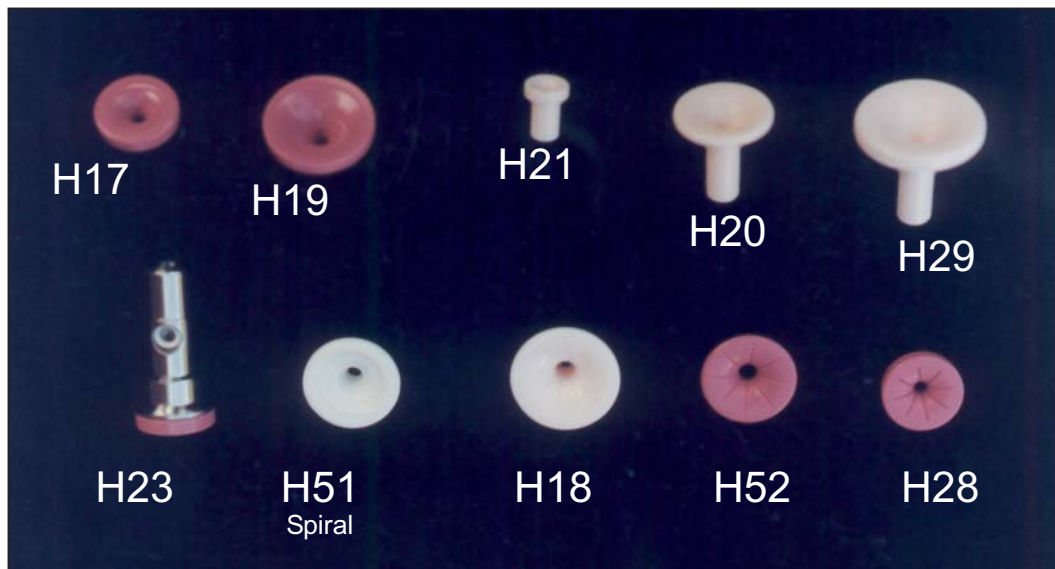

	No. of Yarn Grooves
H59	0
H60	4
H63	8

Hx x M
(standard)
Hx x M1
(with tube eyelet)

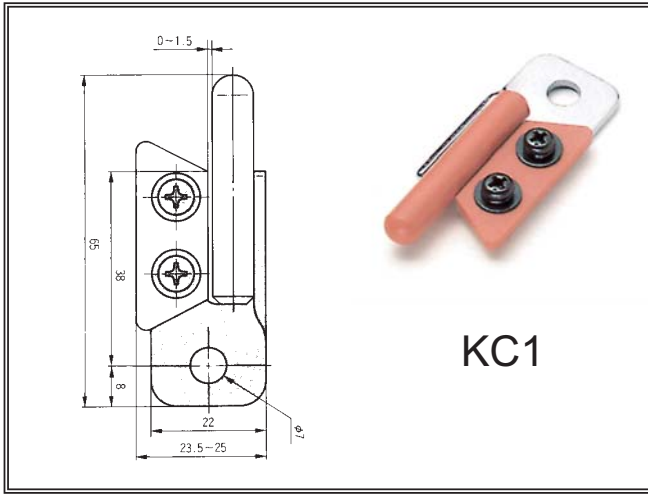

KC1

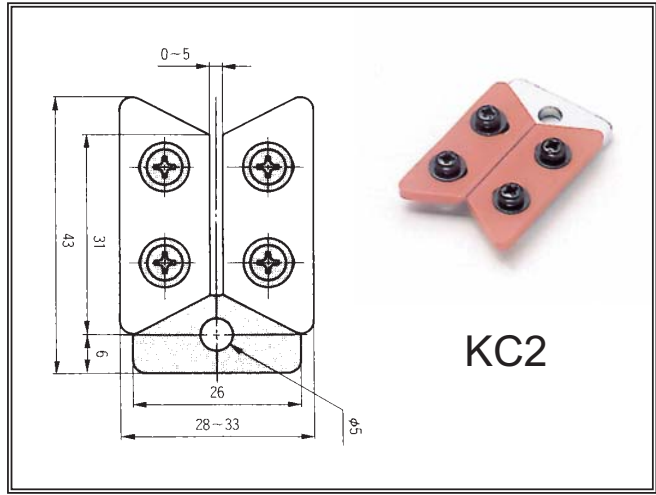

KC2

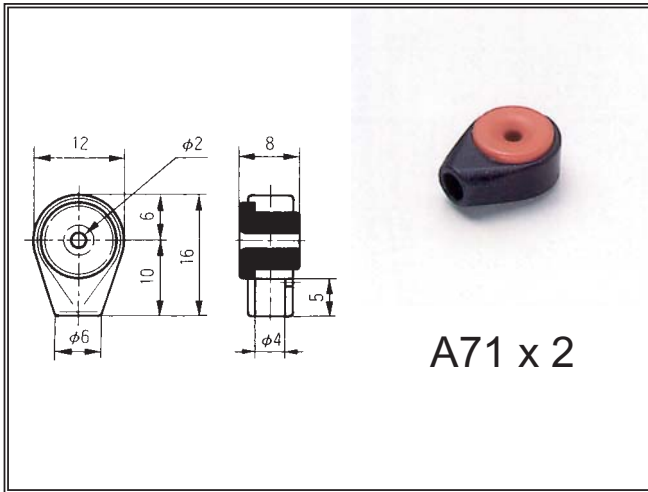

A71 x 2

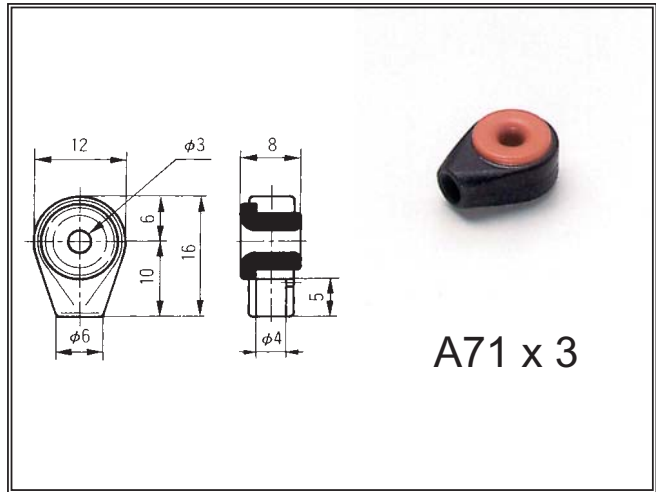

A71 x 3

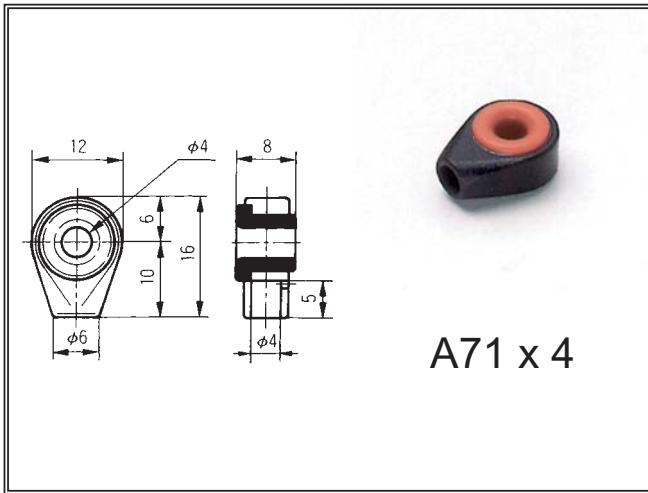

A71 x 4

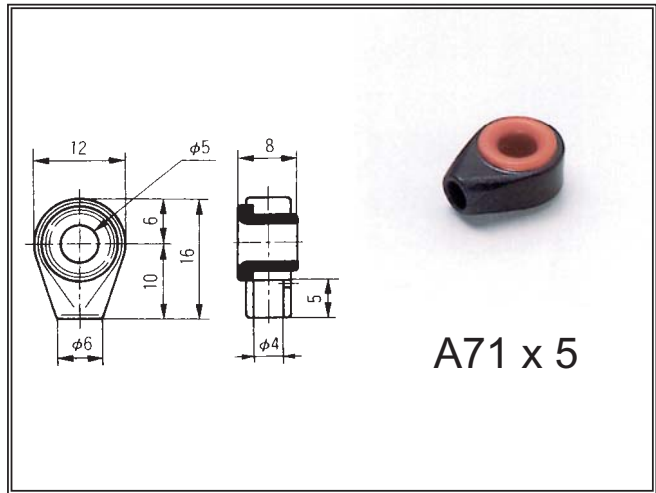

A71 x 5

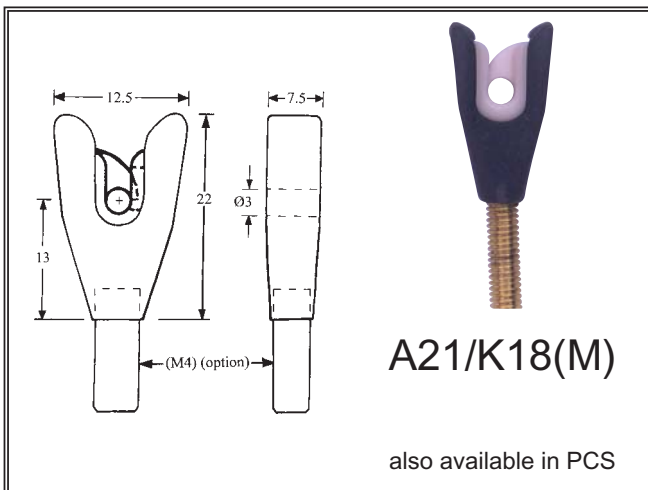

A21/K18(M)

also available in PCS

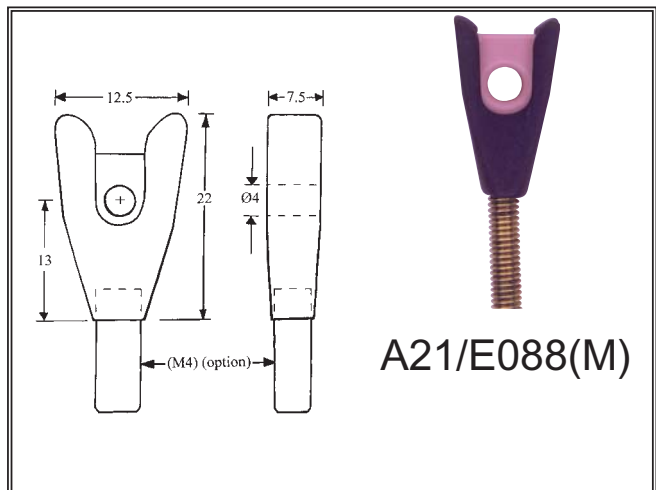

A21/E088(M)

C13R/M4
(C13R/M5)
(C13R/M6)

C20R/M4
(C20R/M5)
(C20R/M6)

Left hand also available

D18LM

Right hand also available

D18L/M6

Right hand also available

R43/M4
(R43/M5)
(R43/M6)

R11/M4
(R11/M5)
(R11/M6)

S132/M4
(S132/M5)
(S132/M6)

(S132M = M3; no collar)

S35/M4
(S35/M5)
(S35/M6)

(S35M = M3; no collar)

A62/L2

also available in PCS

A62/L3

also available in PCS

A63/K18

also available in PCS

A64/K18

also available in PCS

X27

X28

